

Ground Floor

First Floor

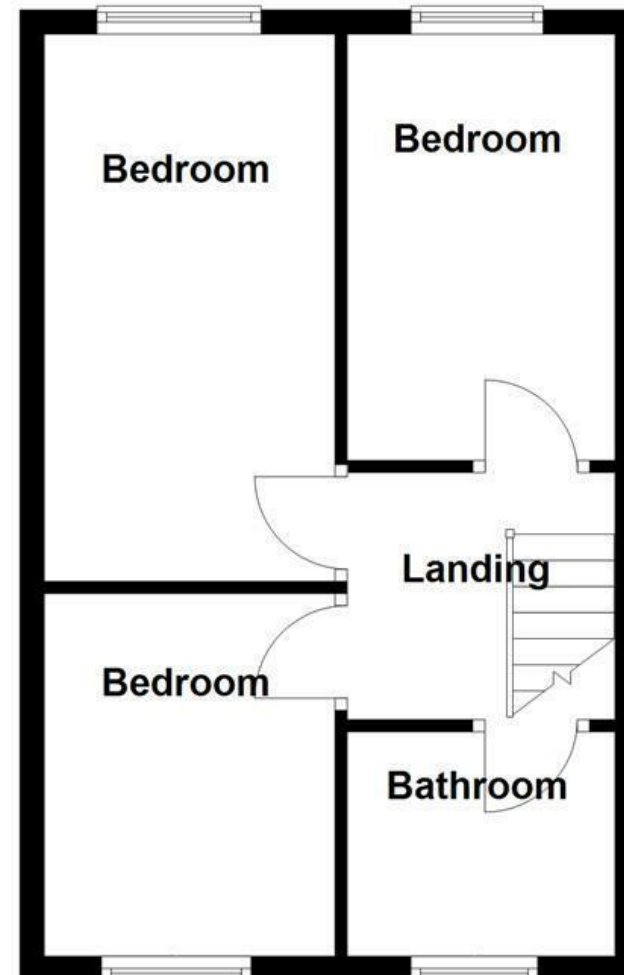
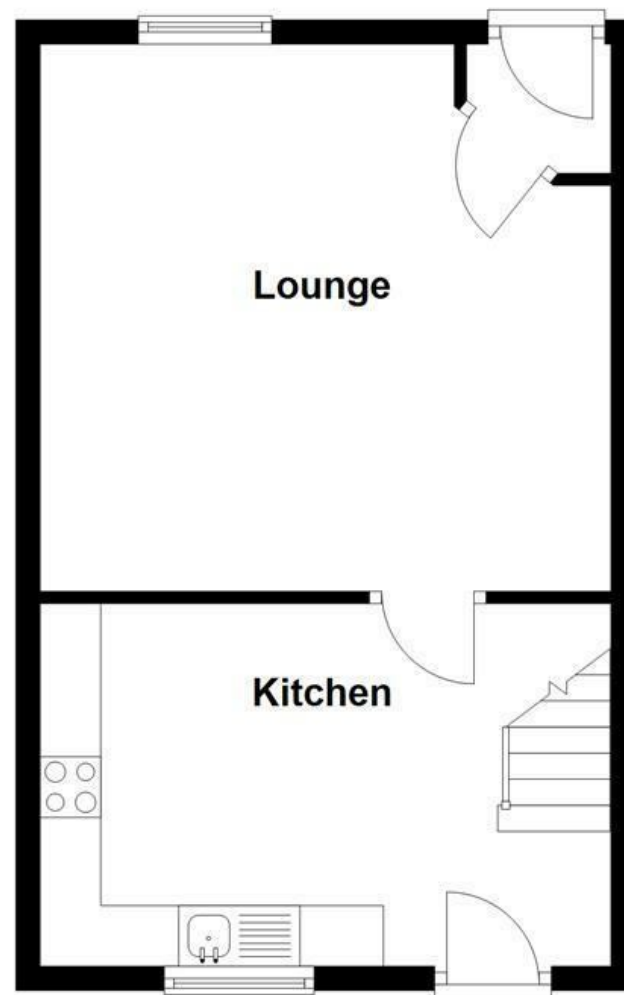

Energy Efficiency Rating		
	Current	Potential
Very energy efficient - lower running costs		
(92 plus) A		87
(81-91) B		
(69-80) C	75	
(55-68) D		
(39-54) E		
(21-38) F		
(1-20) G		
Not energy efficient - higher running costs		
England & Wales	EU Directive 2002/91/EC	

These particulars, whilst believed to be accurate are set out as a general outline only for guidance and do not constitute any part of an offer or contract. Intending purchasers should not rely on them as statements of representation of fact, but must satisfy themselves by inspection or otherwise as to their accuracy. No person in this firm's employment has the authority to make or give any representation or warranty in respect of the property.

Rosehill Street, Heywood, OL10 3DA

Offers Over £160,000

This delightful 3-bedroom terrace property offers a fantastic opportunity for those seeking a comfortable family home with outdoor space. Located in a popular and convenient area, the property features a spacious living room and a modern kitchen, providing plenty of room for family gatherings. Upstairs, you'll find three deceptively spacious bedrooms.

The well-maintained bathroom adds to the appeal of the home, providing a relaxing space for all the family. To the rear, the property benefits from a private backyard garden, ideal for outdoor dining, gardening, or simply enjoying some fresh air in a peaceful setting.

With easy access to local amenities, schools, and transport links, this property is perfect for first-time buyers or families looking for a home with both comfort and convenience. Early viewing is highly recommended to avoid missing out on this charming home!

Rosehill Street, Heywood, OL10 3DA
Offers Over £160,000

3 1 1 C

- On Street Parking
- Council Tax Band A
- Chain Free
- Close to local amenities
- EPC Rating C
- Close to Transport Links
- Leasehold

Lounge
14'9" x 10'5" (4.5m x 3.2m)

Kitchen
15'5" x 9'10" (4.7m x 3m)

Bedroom 1
7'10" x 10'9" (2.4m x 3.3m)

Bedroom 2
14'9" x 7'10" (4.5m x 2.4m)

Bedroom 3
7'6" x 11'5" (2.3m x 3.5m)

Bathroom
5'10" x 6'6" (1.8m x 2m)

